

ATTACHMENT for Trimmers

Patent Pending

**Dual Blade rotate
in opposite direction**

Power Rotary Scissors

*Brushcutter
Attachment*

**Reduction
&
Counter Rotating**

STOP FLYING STONES

Prevent scattering



**Solution!!
Danger of mowing**

EDGE TRIMMING

Safety & Easy

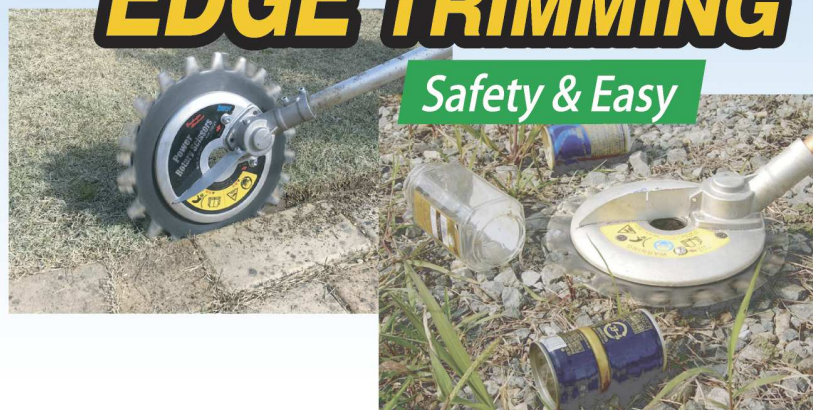

**Stones
flicking up**

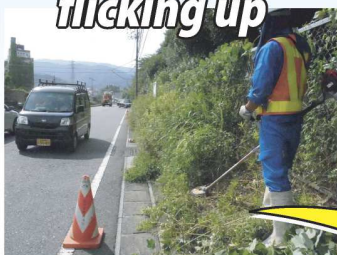

**Prevent accidents
STOP!!**



**Attachable to
the Commercial Trimmers**

IDECH
IDECH CORPORATION
MADE IN JAPAN

Brushcutter
Attachment

Power Rotary Scissors

PROFESSIONAL TOOL for SAFETY

Safety anywhere!!



Grass cutting can be done safely and efficiently in the area of the edge of a road, a park with people.

Prevent Kick back!!



Having less counter force by hitting obstacles, Power Rotary Scissors allows easy edge trimming. Grass in a water area can also be cut with easy and safety.

Braking function of Blade!!

Turning off the Engine throttle instantly, Blade stop.



Mechanism of Safety

Reduction & Counter rotating

Reduction Ratio
20:1

Just place
on the Ground!!

Comfortable
&
Flat cutting

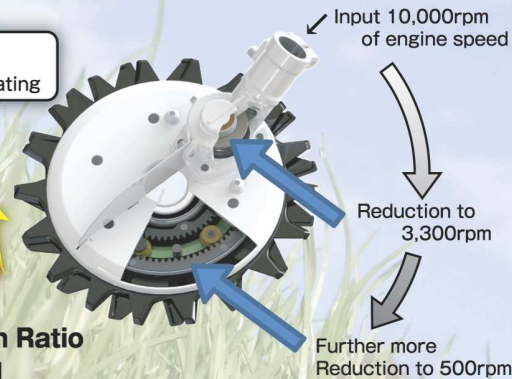

Easy to Maintenance!!

●Exploded view

Body case

Gear unit

Cutter unit



Impact resistance

Improvement against radial direction ratting of gear unit. 6 free rollers securely hold gear unit in position and resist radial thrust.

Dust resistance

Sealing of gear unit is improved by newly employed labyrinth type seal and rubber

Easy maintenance

Gear unit can be completely disassembled and easy to maintain Drive pinion gear is reversible.

Easy Exchanging & sharpening



Fits the Trimmers!!

It's possible to mount Power Rotary Scissors on the commercial trimmers with adapters.

① 24, 25, 25.4, 26mm tube are available

Select the sleeve

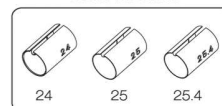

In case of $\phi 26$, sleeve is unnecessary

② Select the adaptor

Diameter	6mm	7mm	7mm	8mm	5.2mm
No. of teeth	10	13	7	9	square

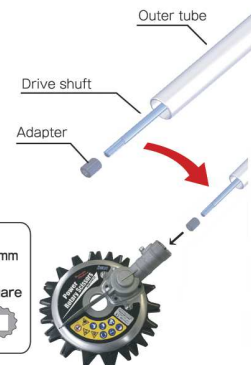

MADE IN JAPAN

IDECH
IDECH CORPORATION

182 Kurita, Hojo-cho, Kasai, Hyogo 675-2302 Japan
TEL:+81-790-42-6688 FAX:+81-790-42-6633
URL:<http://www.idech.co.jp>
E-mail:info@idech.co.jp

VW23-01

1702TN